

4

3

2

1

REVISION HISTORY			
REV	DESCRIPTION	DATE	APPROVED
1	ADDED ELECTRICAL CONNECTIONS	3/13/2015	

B

B

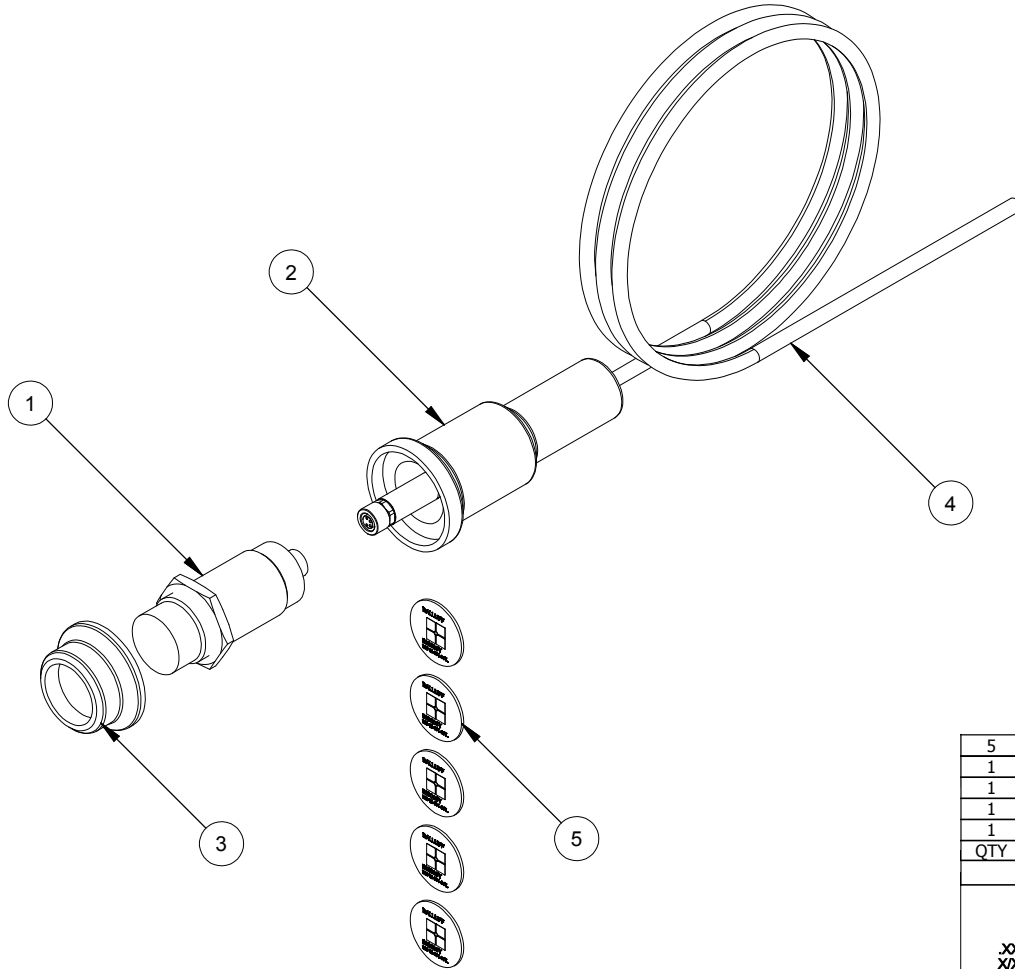

A

A

A

A

4

3

2

1

QTY	ITEM	PART NUMBER	DESCRIPTION	SPECIFICATION
5	5	INV3-CB-RF-TAG	RFID TAG 13.56MHz	BALLUFF, BIS003Y OR BIS M-101-01\L
1	4	E-SEN-03-CBL-50	RFID CABLE, 50FT	BALLUFF, BKS-S115-PU-15
1	3	E-SEN-103-H2	FRONT CAP	1.90" X .8125" DELRIN ROUND BAR
1	2	E-SEN-103-H1	REAR HOUSING	1.90" X 4.437" DELRIN ROUND BAR
1	1	E-SEN-103	RFID SENSOR	BALLUFF, BIS M-400-007-001-00-S115

Parts List			
TOLERANCES		DRAWN	BJS
UNLESS OTHERWISE SPECIFIED		DATE	5/28/2014
ALL DIMENSIONS ARE IN INCHES		APPROVED	
.XX=±.01 XXX=±.003 TIR=±.005		DATE	
X/X=± 1/32 Angular: XX=± 1/2		CHECKED	
DO NOT SCALE DRAWING - WORK TO DIMENSIONS		DATE	
		ISSUED	
		SHEET	1 OF 2
NEXT	FINAL	NEXT ASSY	FINAL ASSY
QTY REQD	APPLICATION		SCALE
PER ASSY			

MAGNUM VENUS PLASTECH
a subsidiary of Graves Spray Supply, Inc.
1862 Ives Avenue, Kent, Washington 98032

13.56MHz READ/WRITE HEAD ASSEMBLY

TITLE

PROJECT

SIZE **B** DWG NO **INV3-CB-RF-50** REV **1**

4

3

2

1



PHOENIX CONTACT 1513334
M12 FIELD CONNECTOR
(LOOKING FROM SCREW TERMINAL SIDE)

BALLUFF RFID READ/WRITE HEAD		
1	BRN	24VDC (31)
2	WHT	COM
3	BLU	24VDC COM (30)
4	PNK	TXD ON PLC
5	GRY	RXD ON PLC
6	YEL	TAG PRESENT (IN15)
7	GRN	NOT USED
8	RED	NOT USED

NOTE: PINS 4 AND 5 ARE SWAPPED
TO MAKE NULL CONNECTION ON FIELD SIDE.

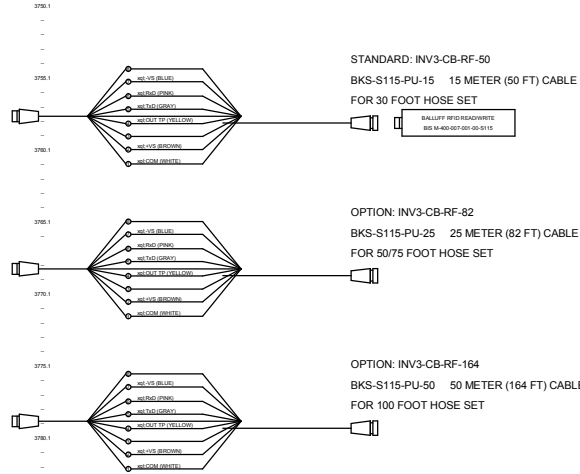

STANDARD: INV3-CB-RF-50
BKS-S115-PU-15 15 METER (50 FT) CABLE
FOR 30 FOOT HOSE SET

OPTION: INV3-CB-RF-82
BKS-S115-PU-25 25 METER (82 FT) CABLE
FOR 50/75 FOOT HOSE SET

OPTION: INV3-CB-RF-164
BKS-S115-PU-50 50 METER (164 FT) CABLE
FOR 100 FOOT HOSE SET

REV	DATE	DESCRIPTION
1	5/28/2014	ISSUED FOR MANUFACTURE

PROPERTY OF MAGNUM VENUS PLASTECH
This part, or drawing, is the property of MAGNUS VENUS PLASTECH and is loaned to you for your information only. It is to be used, reproduced, used or disclosed in whole or in part, unless in reference to contracts or drawings of this company. Nothing contained herein shall be construed to constitute an offer of any product or service of MAGNUS VENUS PLASTECH and all rights herein are reserved.

TOLERANCES

UNLESS OTHERWISE SPECIFIED
ALL DIMENSIONS ARE IN INCHES
XX=±.01 XXX=±.003 TIR=±.005
X/X=± 1/32 Angular: XX=± 1/2
DO NOT SCALE DRAWING - WORK TO DIMENSIONS

DRAWN	BJS
DATE	5/28/2014
APPROVED	
DATE	
CHECKED	
DATE	
ISSUED	
SHEET	2 OF 2
SCALE	

MAGNUM VENUS PLASTECH
a subsidiary of Graves Spray Supply, Inc.
1862 Ives Avenue, Kent, Washington 98032

13.56MHz READ/WRITE HEAD ASSEMBLY

TITLE

PROJECT

SIZE	B	DWG NO	INV3-CB-RF-50	REV	1
------	---	--------	---------------	-----	---

4

3

2

1