

BOS-3100-FIT CATALYST PROPORTIONER ASSEMBLY

10-22-99 (BT2)

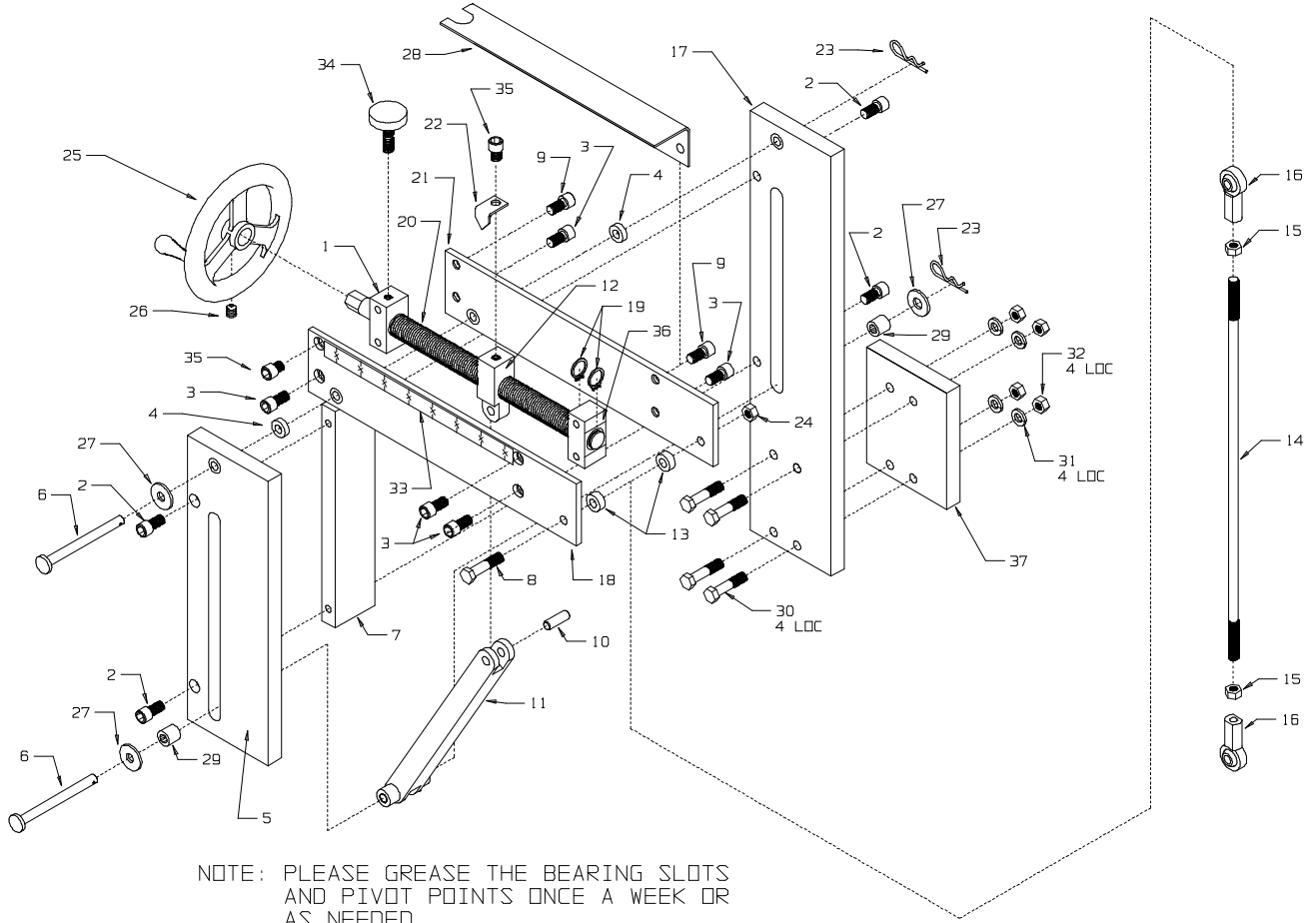

NOTE: PLEASE GREASE THE BEARING SLOTS AND PIVOT POINTS ONCE A WEEK OR AS NEEDED.

**BOS-3100-FIT
CATALYST PROPORTIONER ASS'Y
10-22-99
PARTS KEY**

ITEM	PART #	DESCRIPTION	QTY
1	BOS-3041	LEAD SCREW MOUNT	1
2	F-CS-04C-12	CAP SCREW	4
3	F-CS-04C-06	CAP SCREW	5
4	BOS-3008	SPACER	2
5	BOS-3101-01	GUIDE BRACKET	1
6	BOS-3052	RETAINING ROD	2
7	BOS-3002	SPACING BLOCK	1
8	F-HB-04C-24	HEX BOLT	1
9	F-CS-04C-08	CAP SCREW	2
10	BOS-3014	LINKAGE PIN	1
11	BOS-3040	DRIVE LINKAGE	1
12	BOS-3011	ADJUSTING BLOCK	1
13	BOS-3009	SPACER	2
14	BOS-3027	DRIVE ROD	1
15	F-HN-04F	HEX NUT	2
16	MS-1022	EYE BEARING	2
17	BOS-3103-01	GUIDE BRACKET	1
18	BOS-3004-01	DRIVE ARM	1
19	BOS-3056	RETAINING RING	2
20	BOS-3054	LEAD SCREW	1
21	BOS-3005-01	DRIVE ARM	1
22	BOS-3029	POINTER	1
23	CSP1-9B	HITCH PIN	2
24	F-LN-04C	HEX NUT	1
25	BOS-3034	HAND WHEEL	1
26	F-SS-05C-06	SET SCREW	1
27	F-QSW-04	FLAT WASHER	3
28	BOS-3037	DUST COVER	1
29	BOS-3104	BEARING	2
30	F-HB-04C-24-GR5	MOUNTING BOLT	4
31	F-SW-04	LOCK WASHER	4
32	F-HN-04C	HEX NUT	4
33	BOS-3026-B	4.6 GPM FL. SECTION	1
34	BOS-3015	THUMB SCREW	1
35	F-CS-04C-04	CAP SCREW	2
36	BOS-3055	LEAD SCREW MOUNT	1
37	DUAL-2008	SPACER BLOCK	1